

# LIQUID PUMPS

Dry Lift	Mtrs Head	Flow
8m	20m	5 l/min

Patent Pending

## RD5 Series

### ROTARY DIAPHRAGM PUMP

◆ **revolutionary pumping principle**

An eccentrically mounted bearing on the shaft, rotates within a flexible diaphragm. As the shaft rotates, the bearing flexes the diaphragm, squeezing the liquid through the pump. Self priming to 8 metres, this pump out performs most diaphragm and peristaltic pumps.

◆ **contamination free pumping of liquids**

This self priming rotary diaphragm pump is of a seal-less design and is suitable for many types of applications including beverage dispensing, condensate removal, detergent dosing and liquid transfer. The RD5 is ideal for continuous duty especially where the system can be run dry for short periods.

◆ **flexibility and reliability**

The liquid comes into contact with only two parts being the Santoprene diaphragm and the GF Noryl pump body which are also available in optional food grade materials (see pump options). The pump has no sliding parts so wear and maintenance is kept to a minimum.

◆ **various motor voltage options**

The RD5 is available for either an AC or DC power supply

AC version, for 230V 50Hz or 110V 50/60Hz.  
DC version, for 12V or 24V.

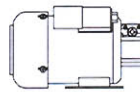

**RD5S single pump (AC & DC version)**

OEM model for building into equipment. The sinusoidal output waveform is suitable for most

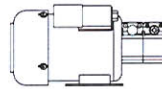

**RD5D double pump (AC & DC version)**

OEM model for building into equipment. Twin pump heads are normally supplied internally connected in parallel to produce a smooth flow. Twin pump heads can be supplied unconnected to pump two separate liquids simultaneously with sinusoidal outputs (please telephone for further

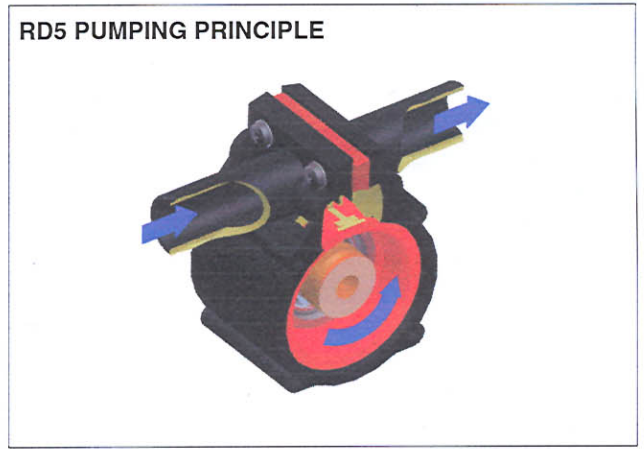
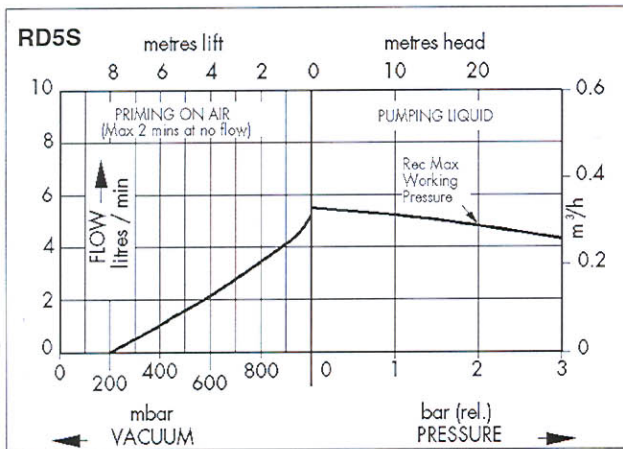

Our sales engineers are at your service to assist in selecting the most appropriate model from our extensive range of pumps and

Our state of the art, research and development department is able to design new pumps from concept to production to meet client requirements.

We have manufactured pumps in large or small quantities for over 40 years. Every pump is tested before it leaves our factory and our extensive in-house facilities are fully accredited to ISO 9001.



Charles Austen  
Pumps Ltd



Royston Road, Byfleet, Surrey KT14 7NY England/UK Tel: +44 (0)1932 355277

Fax: +44 (0)1932 351285 Web: www.charlesausten.com E-mail: info@charlesausten.com

**Motors:** Fitted with shielded ball races throughout.  
IP44. Thermal Protection - AC version only.

model	product code	voltage frequency	operating current	max. load	fuse rating	motor type	speed
RD5S	X87-001	110V / 50-60Hz	0.9A	1.0A	3A	permanent capacitor	2800
	X87-002	230V / 50Hz	0.45A	0.50A	2A	permanent capacitor	2800
	X87-201	12V / DC	4.8A	6.3A	10A	DC brush	3000
	X87-202	24V / DC	2.4A	3.2A	7A	DC brush	3000

### Connectors:

Integral, plain horizontal 15mm OD  
Suitable for standard push-fit connectors

### Performance:

model no.	flow at zero head l/min	dry vacuum mbar	max. lift (dry) metres	nominal max. head metres	max. pressure bar
RD5S	5.0	220	8.0	20	2.0

## PUMP MATERIAL OPTIONS

With the choice of polysulphone body, the pump will handle hot water.

Component	Standard	Options
Body	GF Noryl	Polysulphone
Diaphragm	Santoprene	n/a
Non Return Valve	n/a	Viton/stainless steel
By-pass Valve	n/a	stainless steel / Polypropylene

### RD5S AC version

3.3 kg

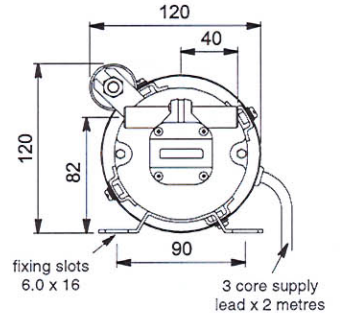
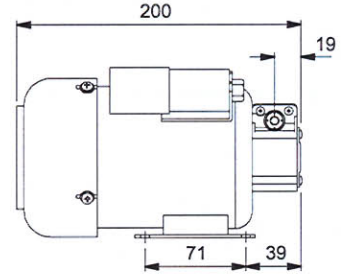

### RD5S DC version

1.5 kg

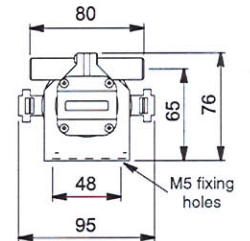
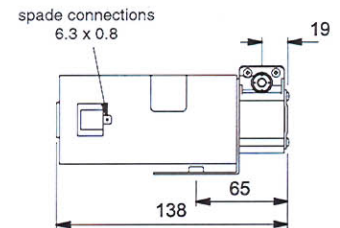

dimensions: mm

Please note that it is important that you ensure the motor specification stated and the range of materials offered in the pump are compatible with the performance, environmental limitations and chemical resistance requirements of the application.

For further information or details of our extensive range of diaphragm pumps, contact our technical sales office who will be pleased to help you select the most suitable pump for your application.

S30-226/3